



Batavus Basket

Disclaimer: Have the accessories fitted by an official Batavus dealer.

Please note: these are instructions for models with and without a steerlock.

You will need:

1. Allen key 5 mm
2. Headset wrench
3. 2x Box wrench 10 mm
4. Torque wrench



Version with steerlock:

Step 1: Put the bicycle on the stand.

Step 2: Remove the handlebar stem, take off the *topcap*, unscrew the *steerlock topnut* and *headtubenut*, and then remove the *spacer* (5 mm).

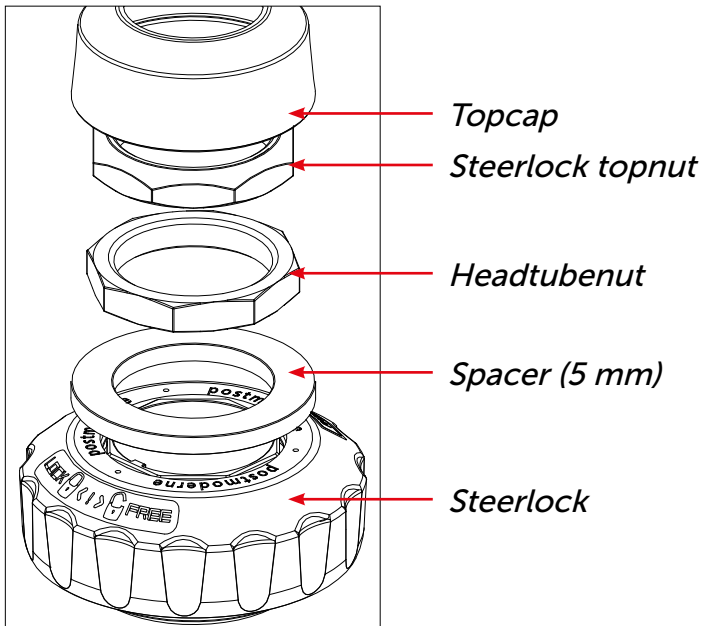

BATAVUS



Batavus Basket

Version with steerlock:

Step 3: Now place the *mounting bracket stem* where the *spacer* was before.

Then fit the following parts in order:

1. *Headtubenut*
2. *Steerlock topnut*
3. *Topcap (lower)*

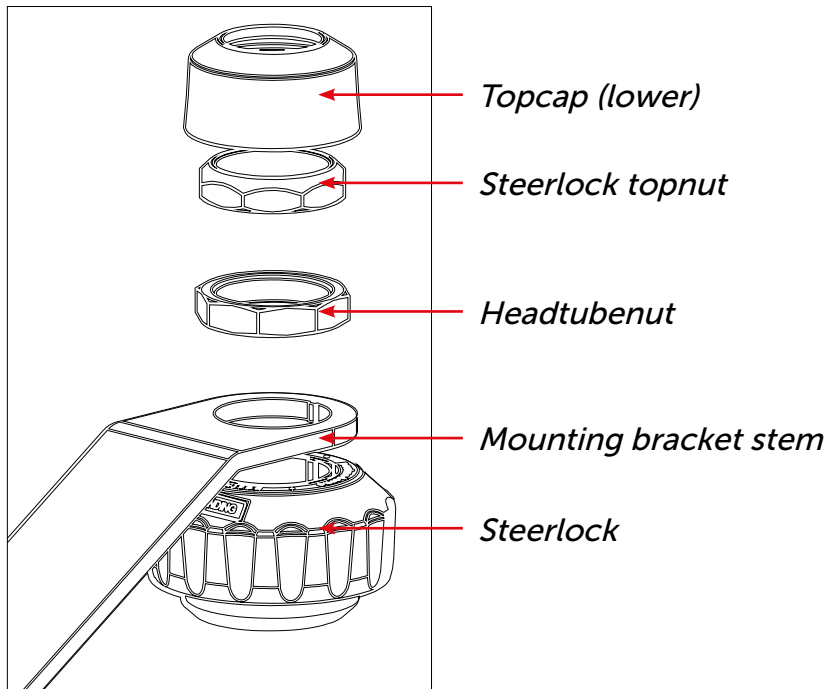

Step 4: Next tighten the *headtubenut* and *steerlock nut*, fit the *topcap* and then replace the handlebar stem and secure it in the right position. Go to page 5 for instructions on fitting the basket.



Batavus Basket

Version without steerlock:

Step 1: Put the bicycle on the stand.

Step 2: Remove the handlebar stem, take off the *topcap*, unscrew the *steerlock topnut* and *headtubenut*, and then remove the *spacer* (5 mm).

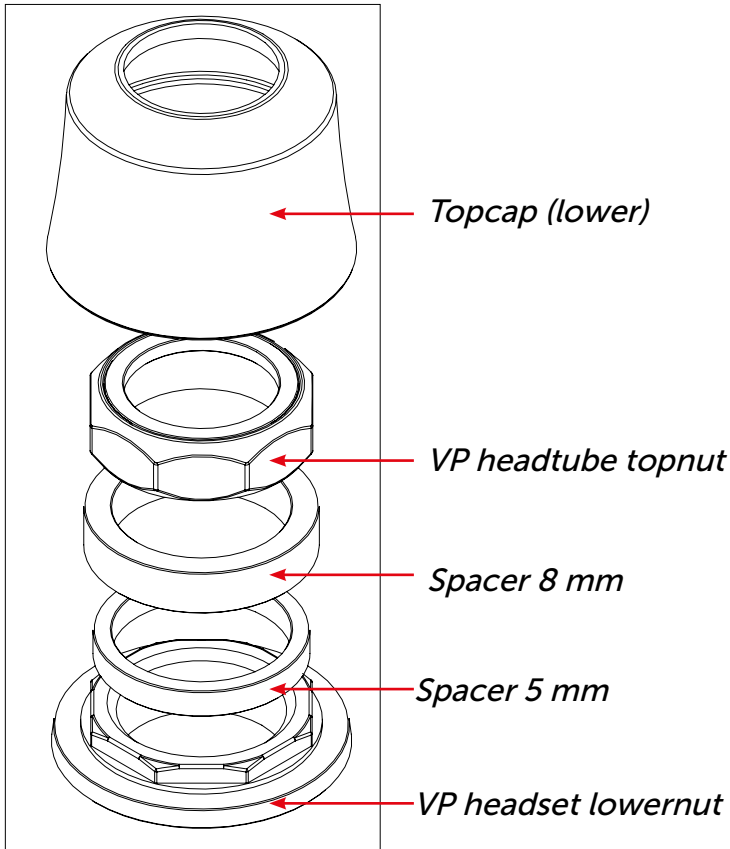



Batavus Basket

Version without steerlock

Step 3: Now place the *mounting bracket stem* where the *spacer* was before.

Then fit the following parts in order:

1. *Headtubenut*
2. *VP headtube topnut*
3. *Topcap (lower)*

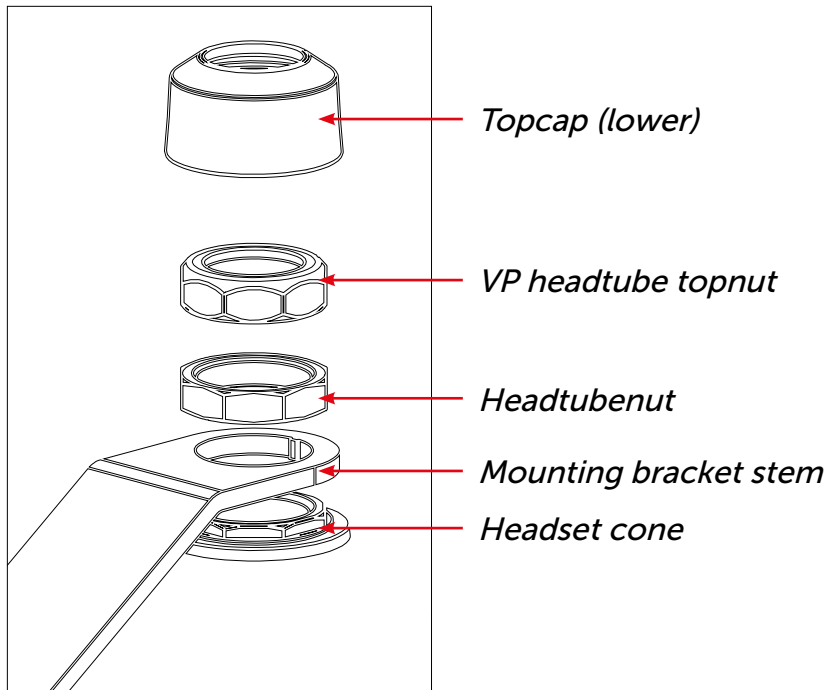

Step 4: Next tighten the *headtubenut* and *VP headtube topnut*, fit the *topcap* and then replace the handlebar stem and secure it in the right position. Go to page 5 for instructions on fitting the basket.



Batavus Basket

Fitting the basket

Step 1: Fit the basket to the *mounting bracket stem* using 2x M6*16 bolts on the inside of the basket, including washers and nut, and fasten hand-tight.

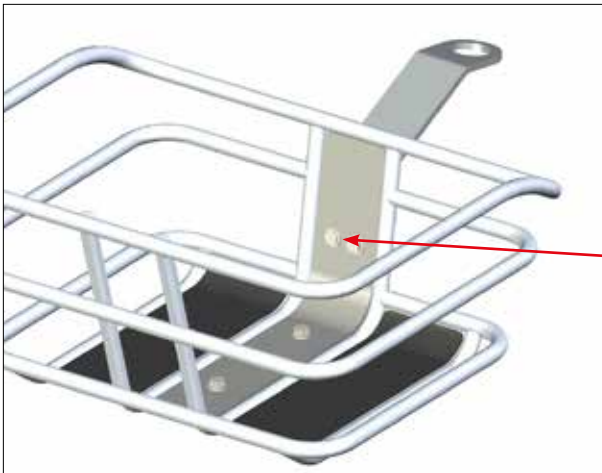

M6 bolts

Step 2: Fit the *mounting bracket front fork* to the basket using 2x M6*16 bolts and also fasten hand-tight.

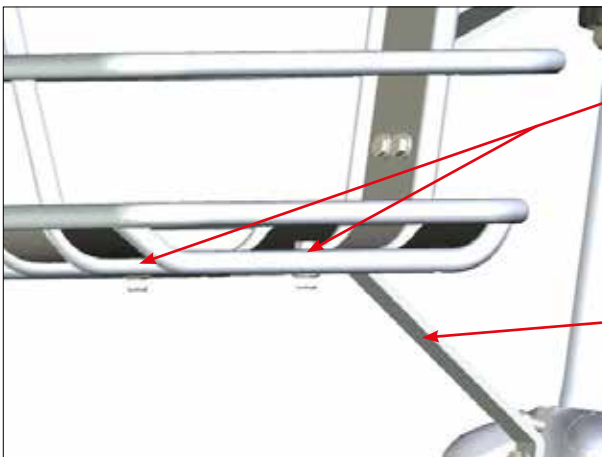

M6 bolts

Mounting bracket
front fork

BATAVUS



Batavus Basket

Step 3: Fit the *mounting bracket front fork* to the fork crown using a 1 x M6*80 bolt, including washers and nut, and fasten hand-tight.

Step 4: Tighten the bolts and nuts of the *basket stem* and *bracket front fork*.

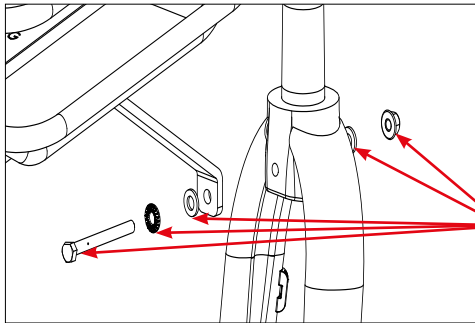

bolt, washers and nut.

Step 5: Check the position of the *basket*, tighten the *bolts* and *nuts* to 8.8 Nm.



Scan QR code for instructions in Dutch, French, German, Danish or Swedish.

BATAVUS